

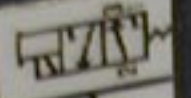



MAC
MODEL MOD
33 Series

PRESSURE
VAC - 100 PSI
VOLTS: 24VDC
WATTS: .50



How to Order 33 Series (8mm Valve)

33A - X X X - RXXX-XXX

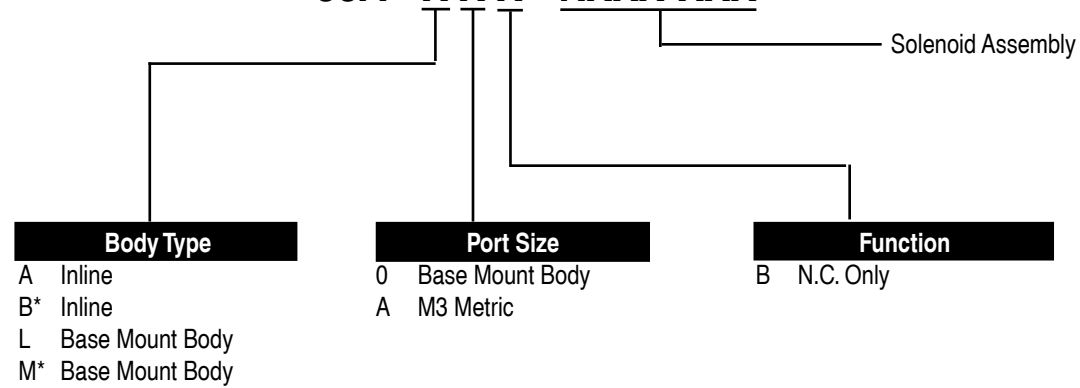

* Use only with solenoids above 4.0 Watts.
MOD number required

How to Order 33 Series Solenoid Assembly

R XX X - X XX

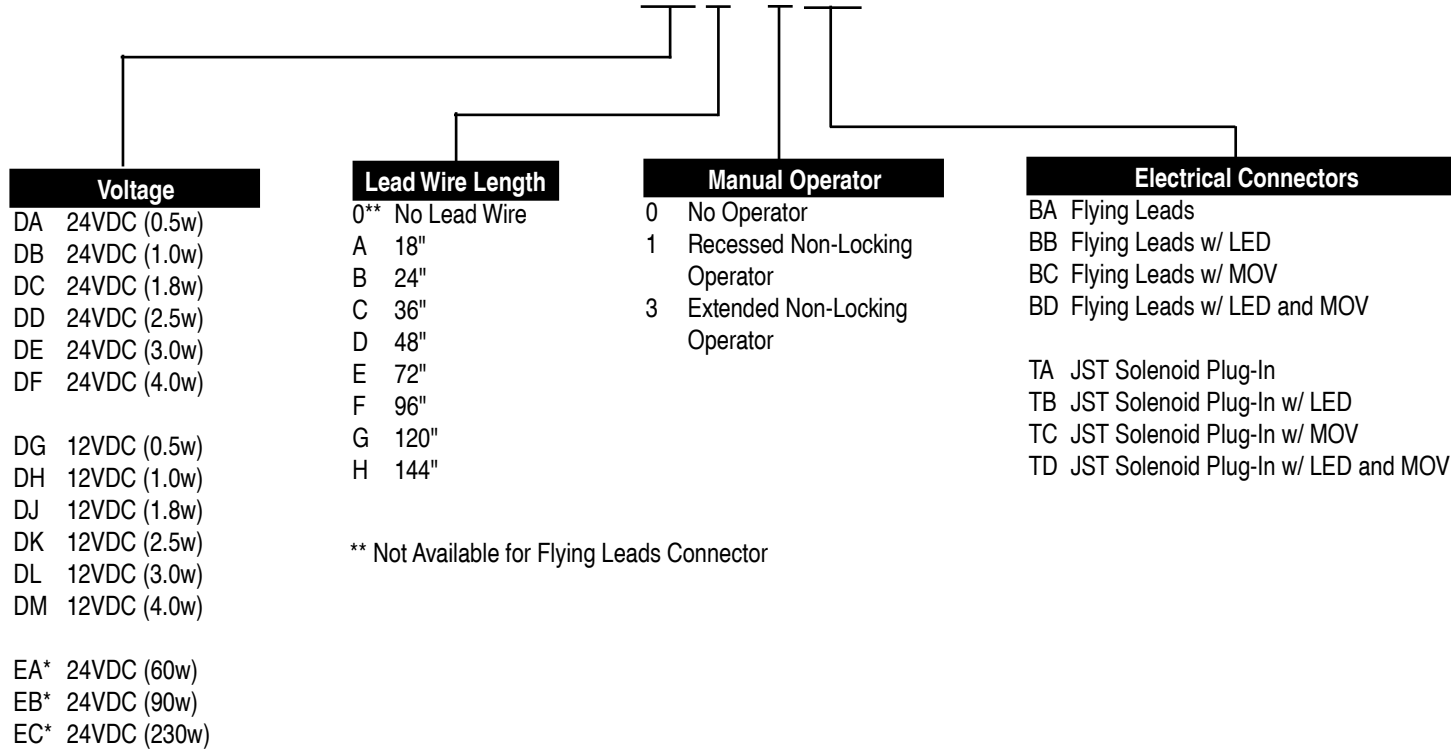

** Not Available for Flying Leads Connector

* MOD numbers required for these voltages

How to Order 33 Series EBM Circuit Bar

EBM33A - XX X X X - XX - 9

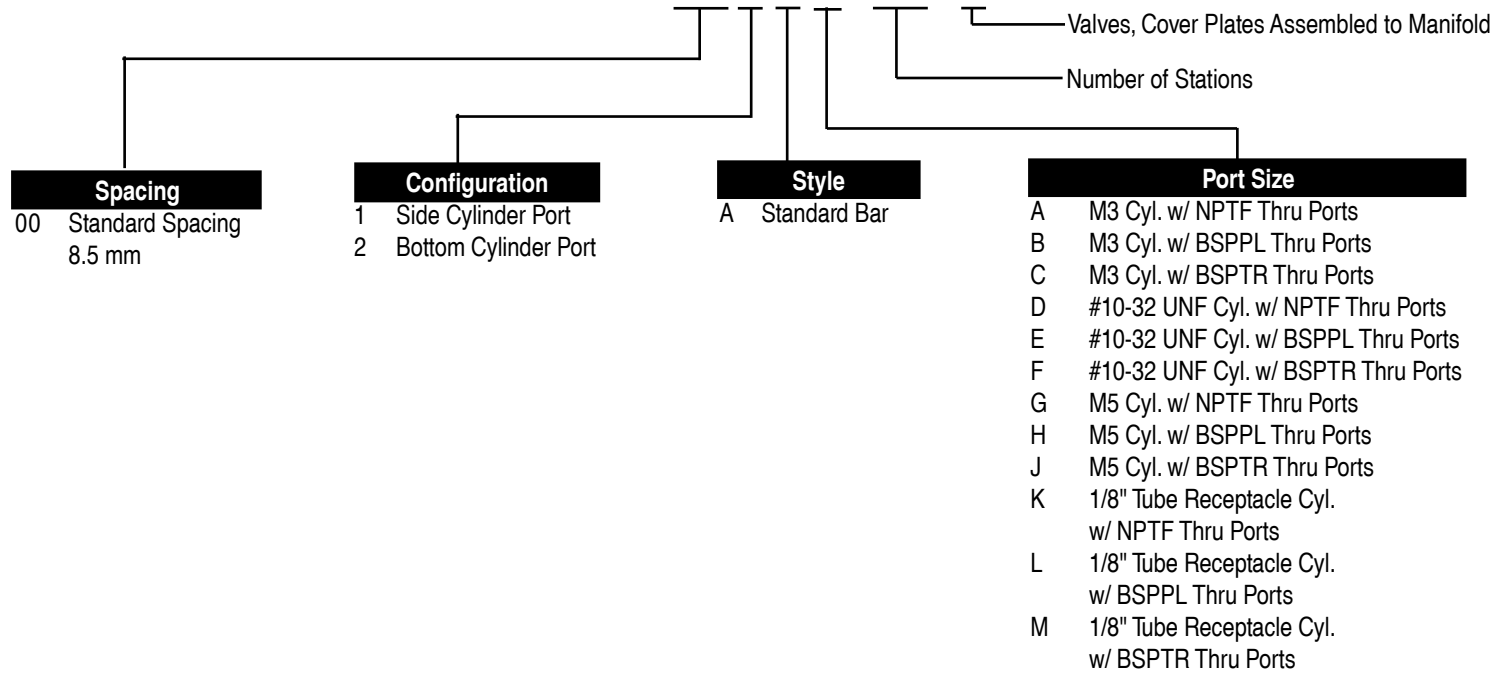

Note: Thru Ports are 1/8"

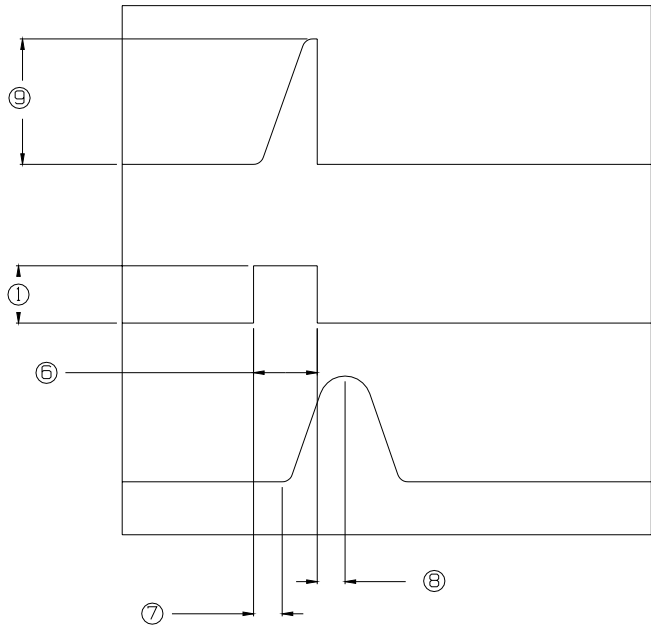

PARAMETERS FOR
MAXIMUM AIR PULSE

1. VOLTAGE
6. ON TIME REQUIRED TO CREATE MAXIMUM AIR PULSE
7. TIME TO START FLOW
8. TIME TO START EXHAUST
9. PEAK CURRENT

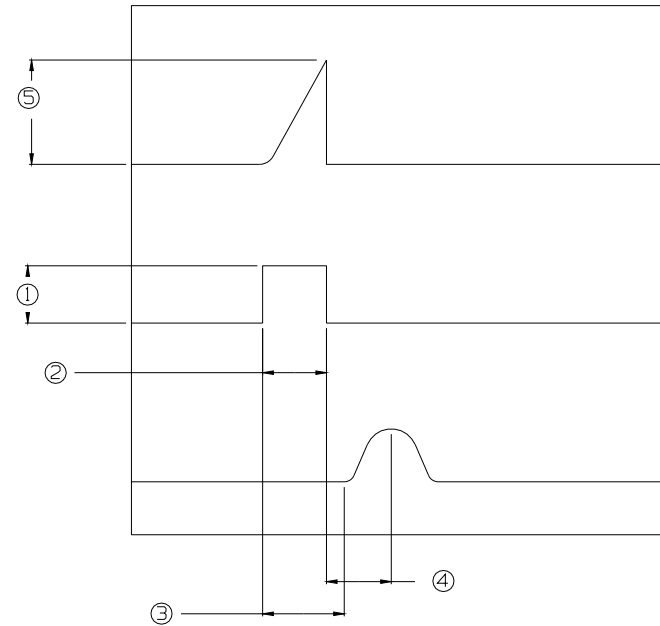

PARAMETERS FOR
MINIMUM AIR PULSE

1. VOLTAGE
2. ON TIME REQUIRED TO CREATE MINIMUM AIR PULSE
3. TIME TO START FLOW
4. TIME TO START EXHAUST
5. PEAK CURRENT

						Trace Description	1	2	3	4	5	6	7	8	9
Valve Model Number	Valve Stroke (in.)	Solenoid Overstroke (in.)	MOD Number (Std. Grease)	MOD Number (Food grade Grease)	Cv (Flow)	Inlet Pressure (psi)	Voltage (VDC)	or Minimum Pulse Magnitude			Values for Maximum Pulse Magnitude				
								On time required to Create Minimum Air Pulse (ms)	Time to Start Flow (ms)	Time to Start Exhaust (ms)	Peak Current (amp)	On time required to Create Maximum Air Pulse (ms)	Time to Start Flow (ms)	Time to Start Exhaust (ms)	Peak Current (amp)
33A-XXX-RECX-XXX	0.004	0.012	S017	S023	0.04	30	24	0.26	0.33	0.33	6.1	1	0.37	0.17	7.8
						80		0.26	0.34	0.3	6.1	1.6	0.38	0.13	7.8
33A-XXX-RECX-XXX	0.006	0.012	S018	S024	0.06	30	24	0.27	0.34	0.32	6.2	1.2	0.37	0.15	7.9
						80		0.26	0.35	0.3	6.1	1.4	0.42	0.15	7.9
33A-XXX-RECX-XXX	0.008	0.01	S019	S025	0.08	30	24	0.28	0.4	0.38	6.3	1.2	0.46	0.2	7.9
						80		0.29	0.37	0.31	6.4	1.3	0.45	0.22	7.9
33A-XXX-RECX-XXX	0.01	0.012	S020	S026	0.1	30	24	0.34	0.49	0.4	7	1.2	0.53	0.23	7.9
						80		0.35	0.47	0.31	7	1.3	0.51	0.23	8
33A-XXX-RECX-XXX	0.012	0.01	S021	S027	0.12	30	24	0.34	0.47	0.39	7	1.2	0.53	0.22	8
						80		0.34	0.47	0.3	7.1	1.2	0.5	0.22	8
33A-XXX-RECX-XXX	0.018	0.012	S022	S028	0.14	30	24	0.43	0.51	0.4	7.4	1.3	0.57	0.26	7.9
						80		0.43	0.51	0.31	7.5	1.3	0.55	0.24	7.9

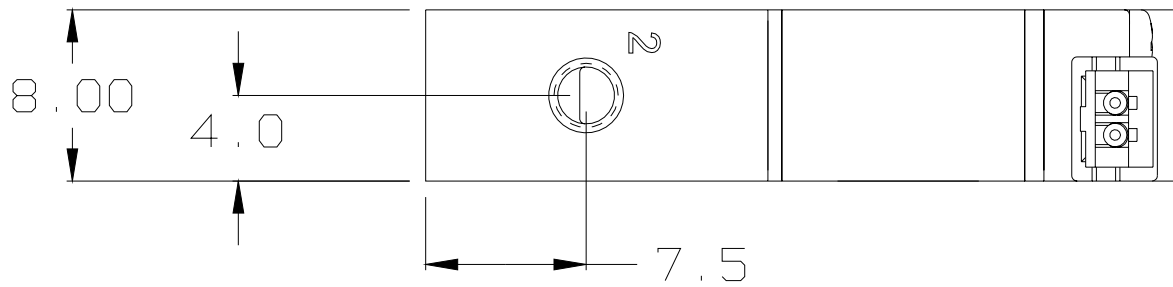
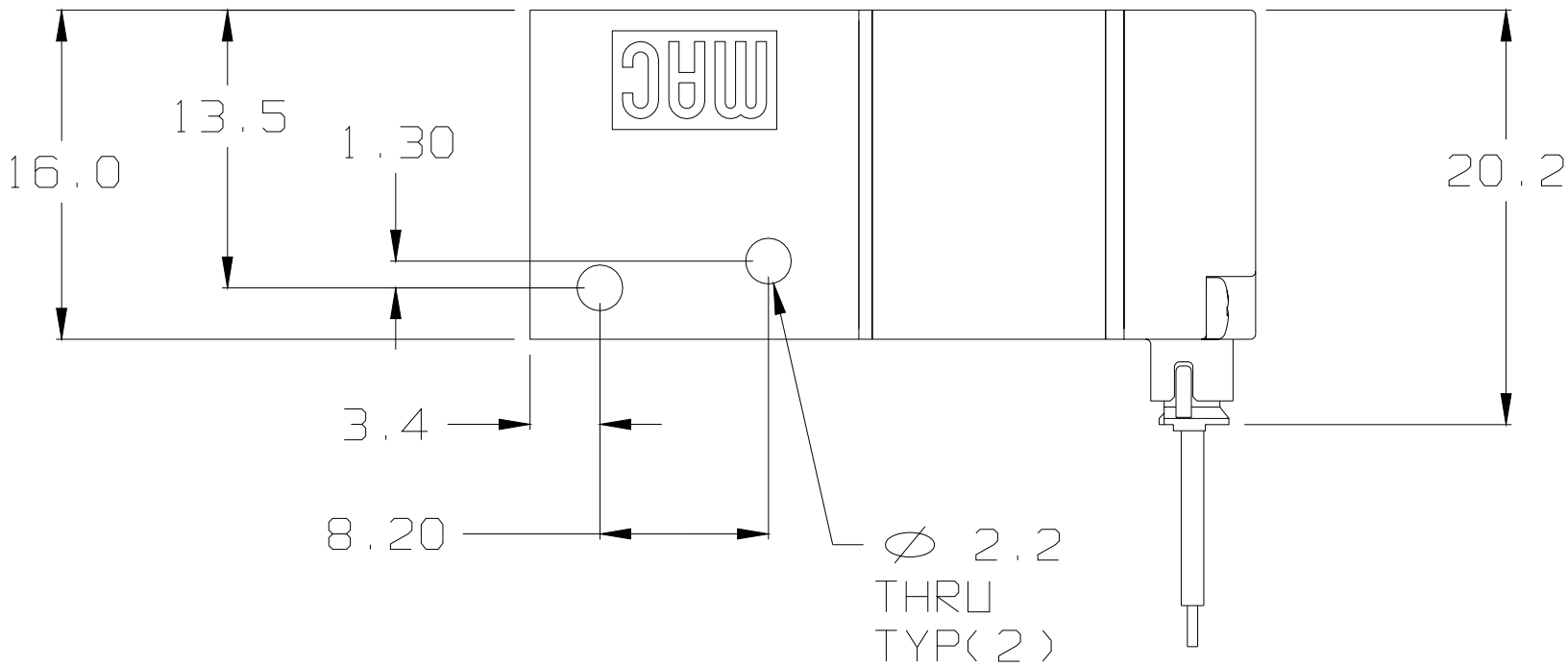
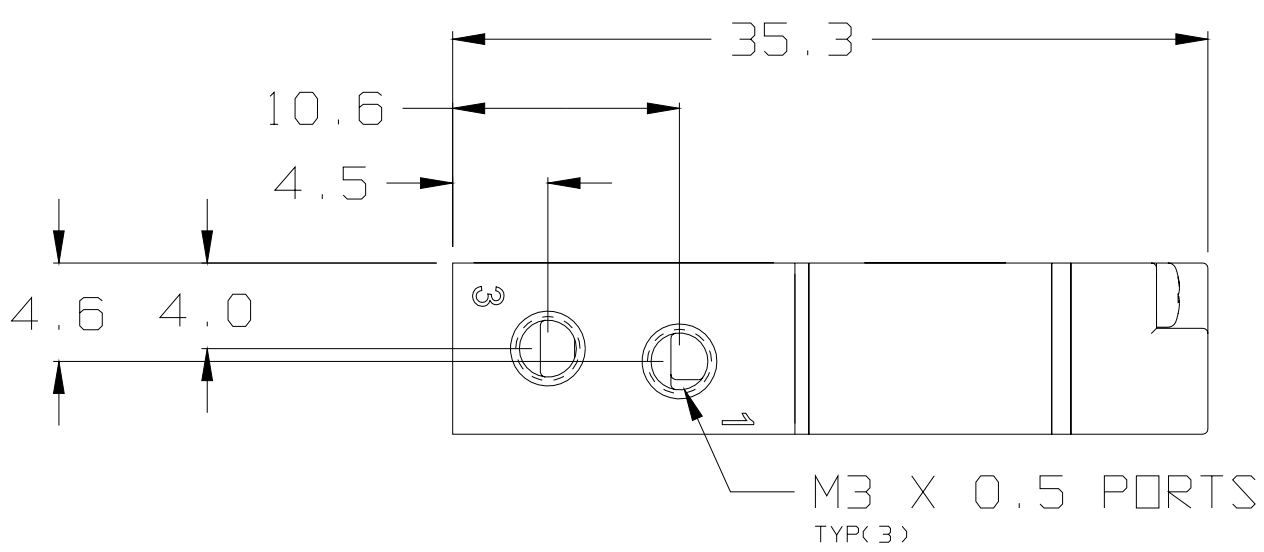

-DIMENSIONS SHOWN ARE
IN MILLIMETERS

33 SERIES INLINE

(SHOWN WITH "JST" CONNECTOR)

33 SERIES EBM

(SHOWN WITH "FLYING LEADS" CONNECTOR)

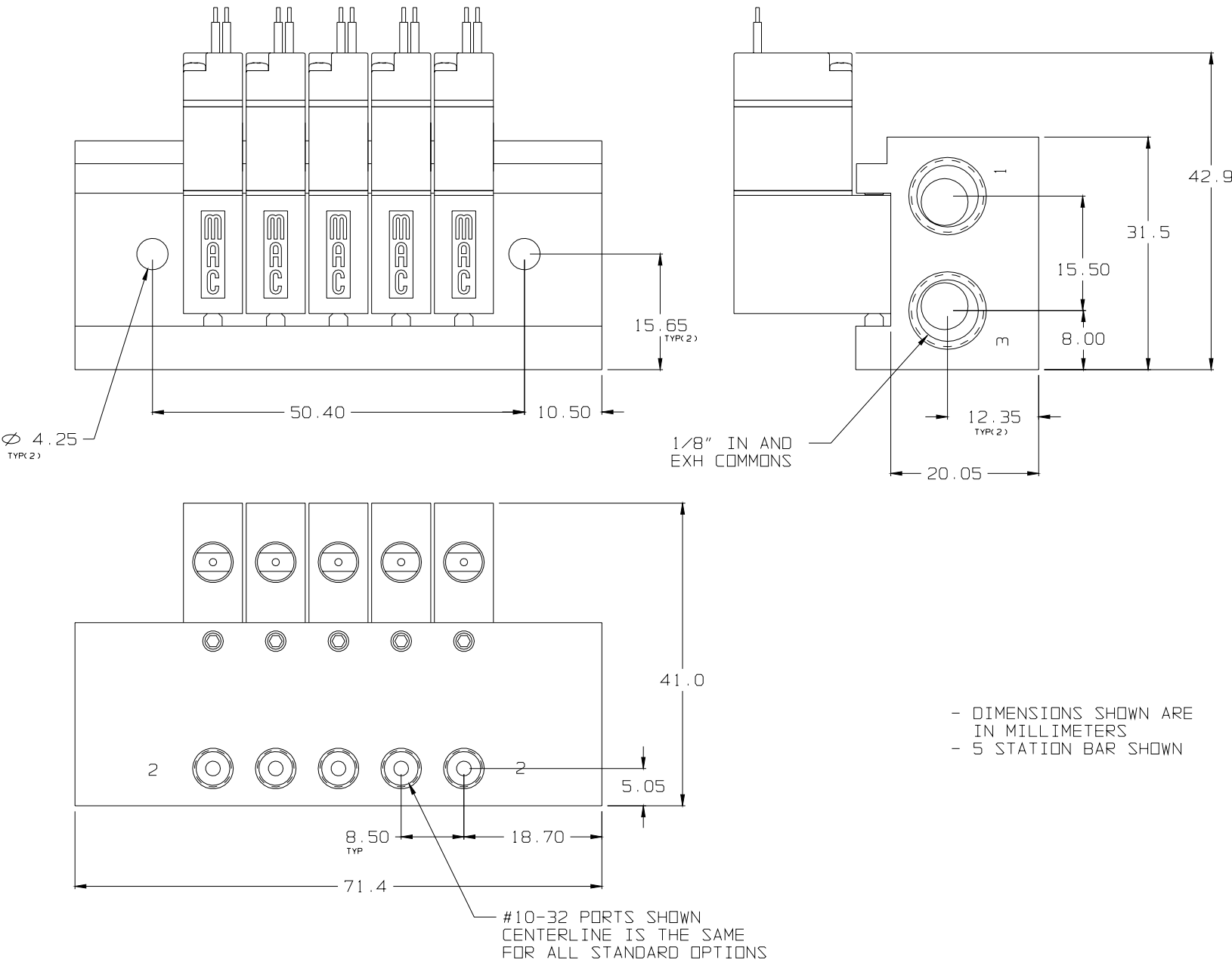

33 SERIES MANIFOLD BODY

(SHOWN WITH "FLYING LEADS" CONNECTOR

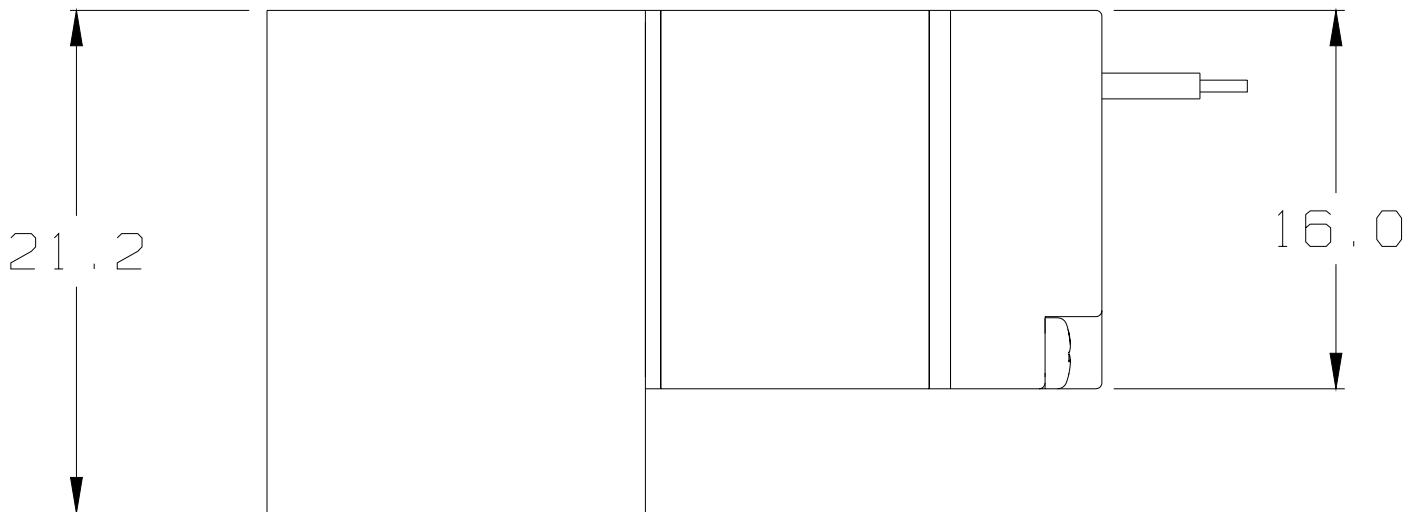
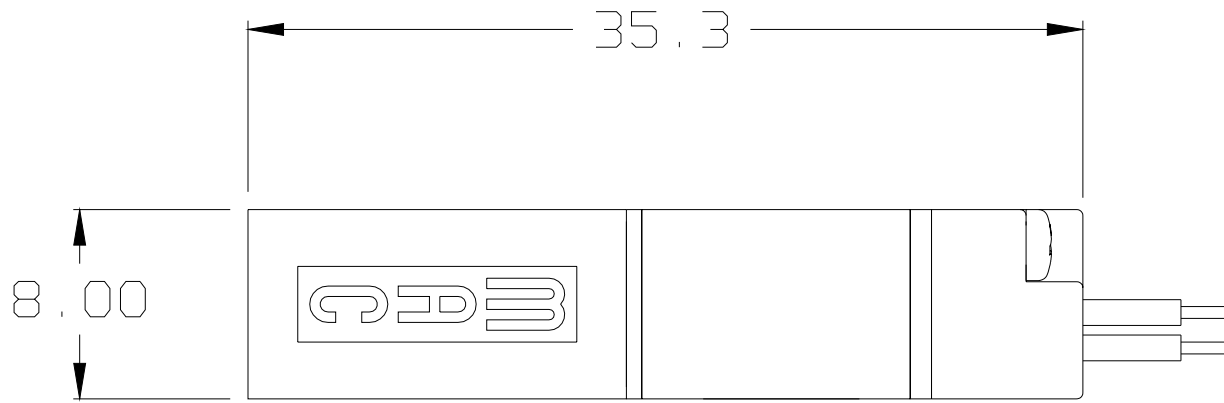

-DIMENSIONS SHOWN ARE
IN MILLIMETERS